

Important:

- Use only with approved DIFFUSION low voltage 24V DC power supplies.
- Do not stare directly into the LED lights when illuminated.
- Do not power the LED ribbon on while it's coiled on a reel.
- Always check polarity for 24V connections, positive (+) to positive and negative (-) negative.
- Do not install indoor versions in areas that are exposed to the elements.
- Route and secure wires so they will not be pinched or damaged.
- Do not install class 2 low voltage wiring in the same runs as AC main power. If AC and low voltage wires cross, keep them at 90 degree angles, if they are running parallel to each other keep them at least six inches apart.
- Warning do not connect LED ribbon light directly to 120v AC power. Only connect to an approved low voltage 24VDC driver.

All wiring must be in accordance with national and local electrical codes, low voltage class 2 circuit. If you are unclear as to how to install and wire this product please contact a qualified professional

Recommended planning:

- Decide where you are going to place the power supply
- How are you going to switch your LED's, will you use a dimmer?
- Plan the best layout configuration for your particular installation.

Note: temporarily mounting LED ribbon light using painters tape and or masking tape allows you to experiment with the light effect before permanent installation.

Power supply:

- Make sure if you are using a dimmer you use the appropriate dimmer rated for the power supply
- Make sure to use a power supply that's wattage is rated higher than your needs.
- * you cannot over power LED ribbon lights using a higher wattage driver*
- Due to voltage drop we do not recommend you exceeding 32ft lengths. Anything longer will require a new home feed .
- Excessive voltage drop can result in LED's flickering or not lighting up at all.

How and where to cut the LED Ribbon

- Use a sharp pair of scissors to cut the LED ribbon.
- Cut directly in in the center of the cut marks on the LED ribbon. On the SL1 it's every 100mm (approx. 4") and SL3 every 50mm (approx. 2").
- Do not cut on the hard solder points .
- You can also solder the 24V power lead wires at these points.



Silicon the Endcaps

- Make sure to put enough silicon into the to prevent water or dust from going through.
- Fasten the outdoor LED strip with the provided clips to the desired surface.

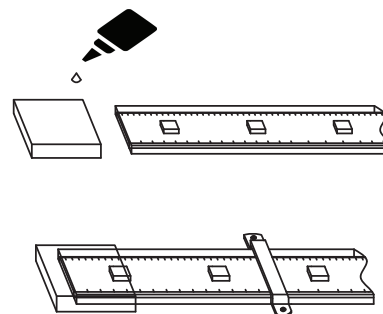

Wiring power supply

- You need to run a 120V AC main feed to the one of the knockouts on the driver and use an appropriate connector to enter into the driver enclosure.
- Then go out the other knockout to your low voltage feed (make sure you use the appropriate size wire for voltage drop).
- Then connect the other side of the low voltage cable you used to a starter feed on the LED ribbon.

Troubleshooting:

LED ribbon light does not light

- √ Make sure your power supply is receiving power.
- √ Confirm you have the correct polarity throughout the LED ribbon.
- √ Make sure all connections are done correctly (ie: polarity) and are not loose.
- √ Make sure your runs do not exceed recommended lengths and consider testing the voltage output and input on the LED driver.

LED ribbon light blinks on, then goes off

- √ Your power supply is too small, check your lengths and wattages and upgrade your power supply or shorten your length of LED ribbon.
- √ One or all of your connection points are loose or polarity was incorrect.

LED's farthest from the power supply are noticeably dimmer

- √ This is usually the cause of voltage drop, check your runs and feeder AWG to make sure they are adequate for the distance.
- √ Make sure you don't have more than the recommended length of continuous runs of LED ribbon.

LED's flicker when dimming

- √ Check to make sure you are using a dimmable approved LED driver for the LED ribbon.
- √ Make sure you are using the correct dimmer for the driver.
- √ Make sure you adjust the trim settings on the dimmer and or for lighting systems.

Limited 5 year warranty

* Improper installation, improper powering, abuse, or misuse for its intended purpose will void warranty. LED ribbon cannot be returned or exchanged once cut unless it's a warranty replacement. Proof of purchase is required for all and any returns or warranty exchanges *

Questions or concerns email info@rjcross.com